

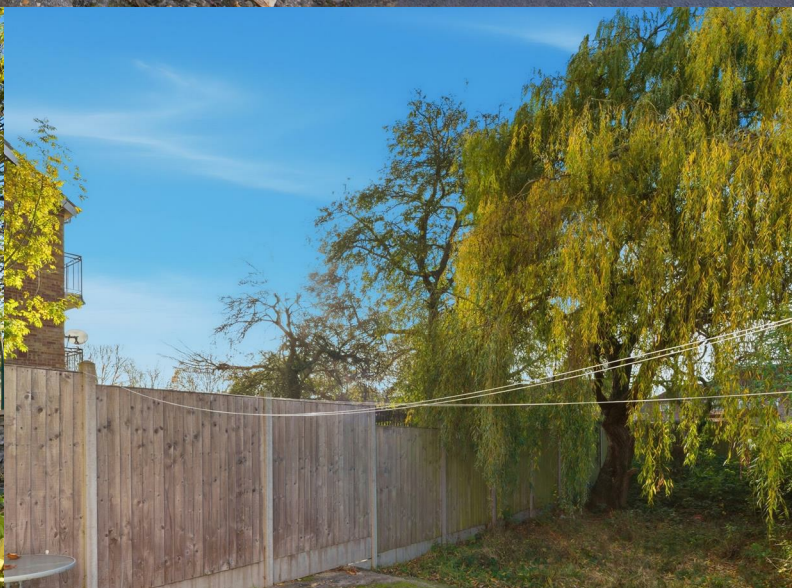

**MOVE INN ESTATES**

MAKING THE RIGHT MOVE



**Croyde Avenue**

, Hayes, UB3 4EJ

**Offers In The Region Of £599,950**





## Floor Plan

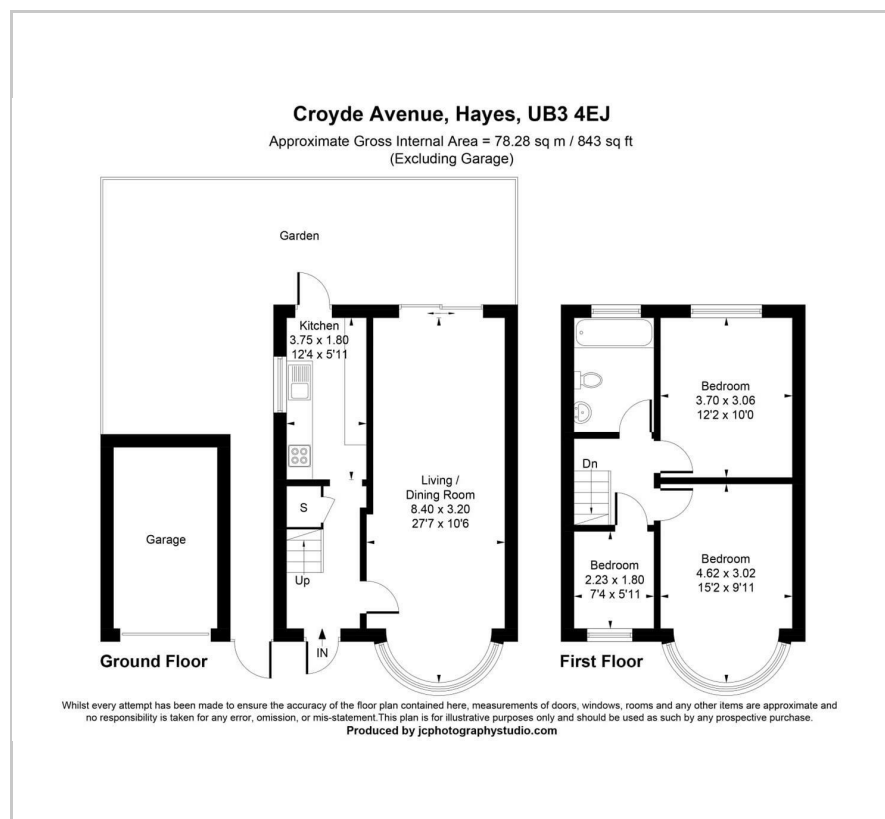

## Area Map



## Energy Efficiency Graph

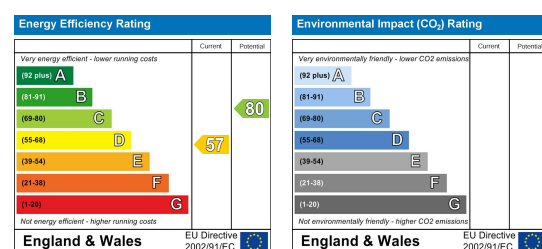

## Viewing

Please contact our Move Inn Estates - Sales Office on 0208 574 4966 if you wish to arrange a viewing appointment for this property or require further information.

- 3 Bedrooms
- Chain Free
- Large plot
- Rear access
- Semi-detached
- Potential to develop a second dwelling STPP
- Driveway

Move Inn Estates proudly present this well-maintained and spacious family home located on the popular Croyde Avenue in Hayes. Offered to the market chain free with a lot of potential to extend or develop another dwelling STPP this property is ideal for those looking to upsize or those looking to build and develop.

The home features a generous reception room, a well-sized fitted kitchen, and thoughtfully arranged bedrooms that provide ample space for family living. The property also benefits from a family bathroom, private rear garden, and off-street parking, making it both practical and appealing.

Situated just moments from local schools, shops, parks, and excellent transport links, including Hayes & Harlington Station and convenient road access to the M4 and A312, the property offers superb connectivity for commuters. Croyde Avenue remains a sought-after neighbourhood, known for its welcoming community and easy access to amenities.

This is a fantastic opportunity to secure a lovely family home in one of Hayes' most popular locations.



These particulars, whilst believed to be accurate are set out as a general outline only for guidance and do not constitute any part of an offer or contract. Intending purchasers should not rely on them as statements of representation of fact, but must satisfy themselves by inspection or otherwise as to their accuracy. No person in this firm's employment has the authority to make or give any representation or warranty in respect of the property.